

Ceiriog Crescent, Rhydyfelin, Pontypridd, CF37 5PH
£180,000



- Two Double Bedrooms
- Great A470/M4 Access
- Combi Boiler
- Perfect First-time-buy
- Close To Local Amenities
- Downstairs Bathroom
- No Onward Chain
- Outbuilding Prime For Conversion

Description...

James Douglas are delighted to welcome this two double bedroom semi-detached property to the market. There is potential to extend (STP). Set in the popular area of Rhydyfelin, Pontypridd. The perfect first-time-buy, investment or for someone looking to downsize. In brief terms the accommodation comprises an entrance porch, open plan living/dining room, kitchen and bathroom on the ground floor. Upstairs there are two double bedrooms. Mains gas fired central heating (Glow-worm combi boiler) and UPVC double glazed windows and doors throughout. Off-road parking for two vehicles. A level plot with block paved off-road parking space to the front. North-west-facing rear garden space complemented by block paving and real grass. There is also a large outbuilding currently being utilized for storage but with huge renovation potential. EPC D potential C. Council tax band B.

****NO ONWARD CHAIN****

****OUTBUILDING PRIME FOR POTENTIAL CONVERSION****

****3D VIRTUAL TOUR AVAILABLE***

****EASY ACCESS ONTO A470/M4 CORRIDOR****

Morien Crescent, Rhydyfelin is within walking distance of the local village shops or within a five minute drive of Pontypridd town centre which includes a wide range of shops and sporting and recreational facilities. The local primary schools are Heol-Y-Celyn Primary School & Hawthorn Primary School with the local high schools being Cardinal Newman R.C. Comprehensive School and Hawthorn High School. There are useful mainline railway stations in Treforest and Pontypridd town centre. Easy access to the M4 motorway brings other major centres including the capital city of Cardiff, Newport and Swansea within commuting distance.

Additional Information

Tenure: Freehold
EPC: C
Council Tax Band: B

Accommodation...

- Entrance Porch
 - Living Room
 - Dining Room
 - Kitchen
 - Hallway
 - Bathroom
 - Landing
- Bedroom One
 - Bedroom Two
 - Outbuilding
 - Outside
 - Directions





Floorplan

Approx Gross Internal Area
97 sq m / 1042 sq ft



Ground Floor
Approx 46 sq m / 493 sq ft

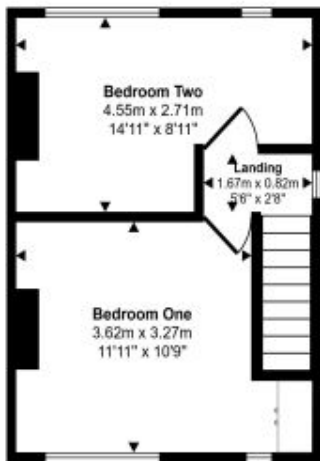

First Floor
Approx 28 sq m / 301 sq ft

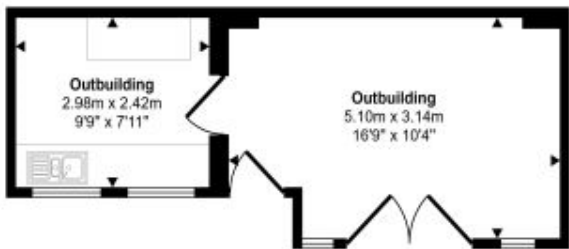

Outbuilding
Approx 23 sq m / 249 sq ft

This floorplan is only for illustrative purposes and is not to scale. Measurements of rooms, doors, windows, and any items are approximate and no responsibility is taken for any error, omission or mis-statement. Icons of items such as bathroom suites are representations only and may not look like the real items. Made with Made Snappy 360.

Energy Rating

