

Woodville Court, Cathays, Cardiff, CF24 4DR
£170,000



- EPC Rating TBC

Description...

Welcome to your dream home! This charming 2-bedroom apartment is now available in a highly desirable area, combining comfort, convenience, and style.

The spacious living area offers a bright and airy atmosphere that's perfect for relaxation or entertaining. The open-plan design creates a welcoming environment, making it easy to unwind after a long day.

Both generously-sized bedrooms provide peaceful retreats, with plenty of natural light and space for your personal touches. The updated kitchen is designed for both functionality and style, featuring sleek cabinetry and modern appliances that make meal preparation a breeze.

The apartment is well-maintained and in good condition, ready for you to move in without any hassle. Plus, with the added benefit of allocated parking, you can say goodbye to parking woes and enjoy the convenience that comes with it.

Situated in a sought-after neighborhood, you will be just a stone's throw away from local amenities, shops, parks, and excellent transport links.

Don't miss out on the opportunity to make this lovely apartment your new home! Whether you're a first-time buyer, a savvy investor, or looking to downsize, this property ticks all the boxes.

Contact us today to arrange a viewing and experience the charm of this wonderful apartment for yourself!

Accommodation...



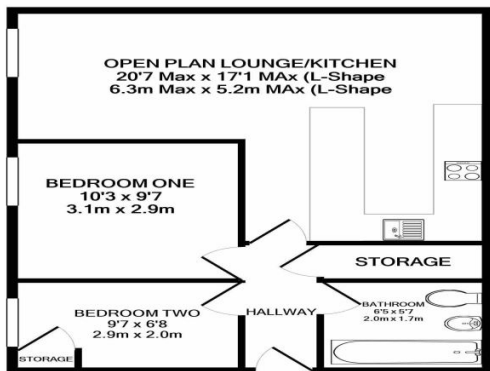

TOTAL APPROX. FLOOR AREA 546 SQ.FT. (50.7 SQ.M.)
 Whilst every attempt has been made to ensure the accuracy of the floor plan contained here, measurements of doors, windows, rooms and any other items are approximate and no responsibility is taken for any error, omission, or mis-statement. This plan is for illustrative purposes only and should be used as such by any prospective purchaser. The services, systems and appliances shown have not been tested and no guarantee as to their operability or efficiency can be given.
 Made with Metropix ©2021

Floorplan

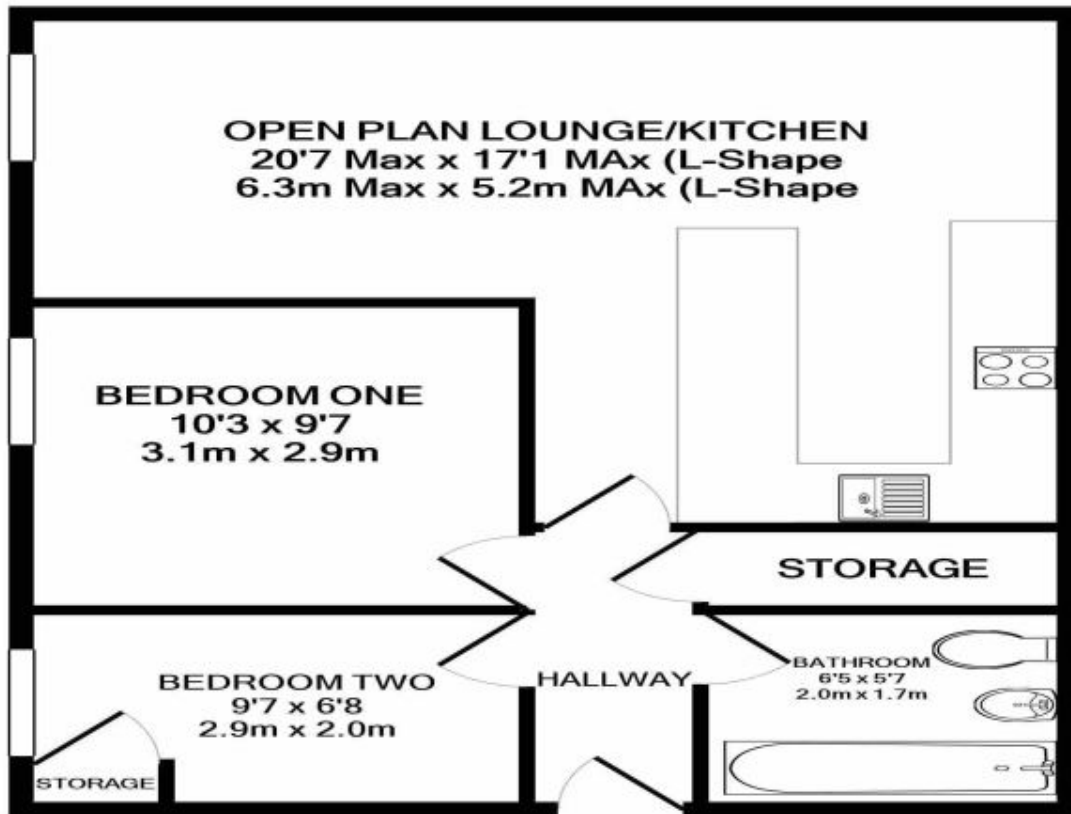

TOTAL APPROX. FLOOR AREA 546 SQ.FT. (50.7 SQ.M.)

Whilst every attempt has been made to ensure the accuracy of the floor plan contained here, measurements of doors, windows, rooms and any other items are approximate and no responsibility is taken for any error, omission, or mis-statement. This plan is for illustrative purposes only and should be used as such by any prospective purchaser. The services, systems and appliances shown have not been tested and no guarantee as to their operability or efficiency can be given
 Made with Metropix ©2021

Energy Rating

Energy Efficiency Rating		Current	Potential
<i>Very energy efficient - lower running costs</i>			
92-	A		
(81-91)	B		
(69-80)	C		
(55-68)	D		
(39-54)	E		
(21-38)	F		
(1-20)	G		
<i>Not energy efficient - higher running costs</i>			
England & Wales		EU Directive 2002/91/EC	